

# Cunard Queen Victoria Deck Plans

## Deck 12

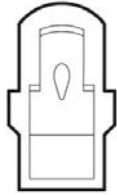

**Grill Exclusive**  
The Grills Upper Terrace

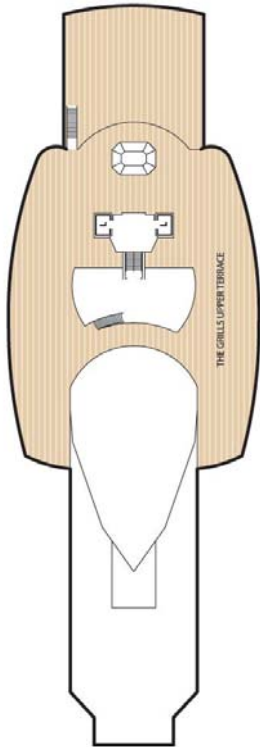

**Queen Victoria**

## Deck 11

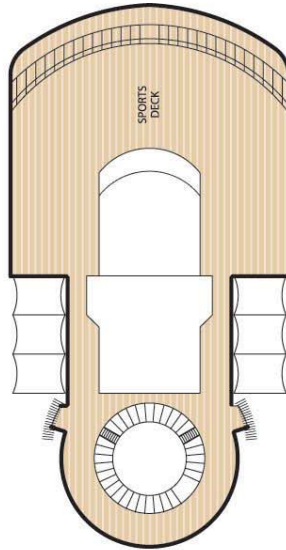

**Grill Exclusives ▼**  
The Terrace  
The Grills Lounge  
The Courtyard  
Al Fresco Dining  
Queens Grill - Left  
Princess Grill - Right

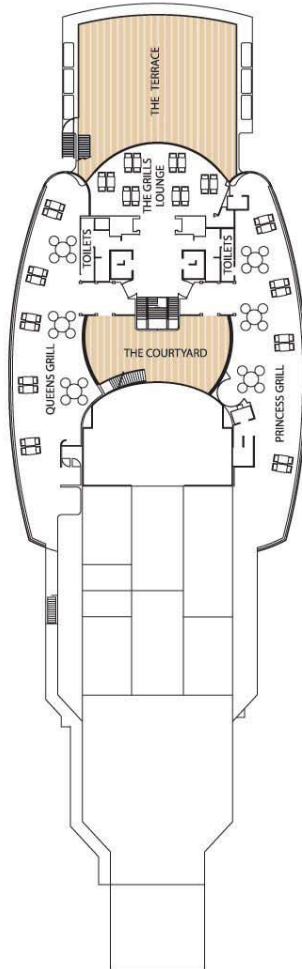

**1-800-845-1717**

## Deck 10

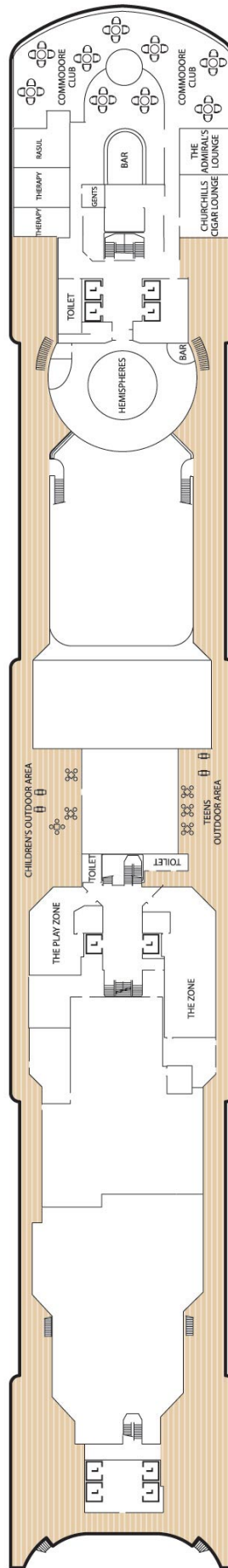

**Info@DeluxeCruises.com**

## Deck 9

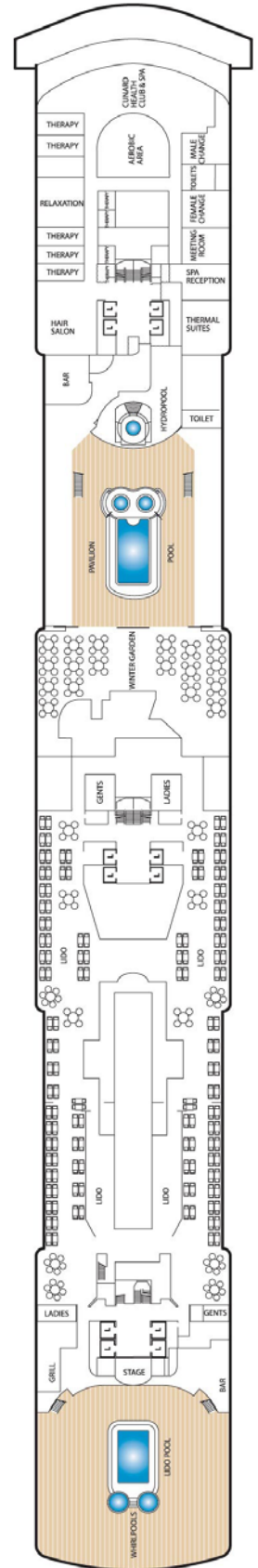

**Queen Victoria**

**1-800-845-1717**

**Info@DeluxeCruises.com**

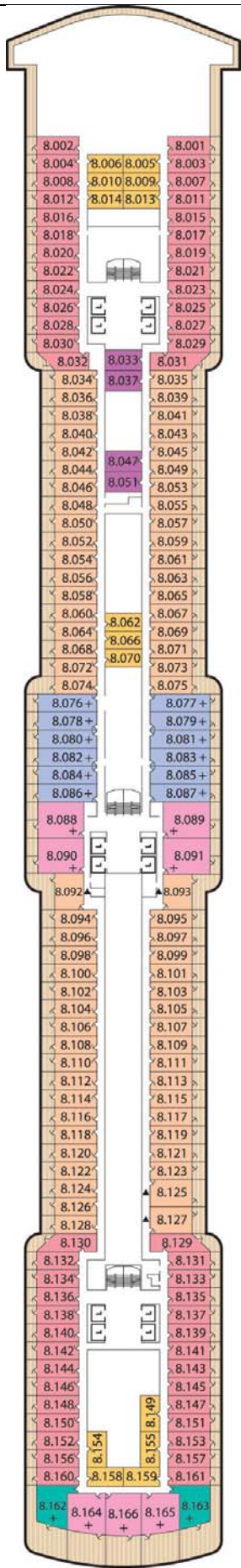

Deck 8

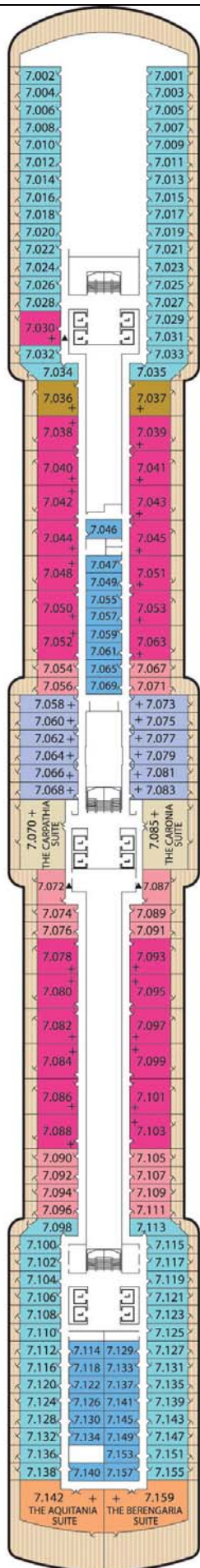

Deck 7

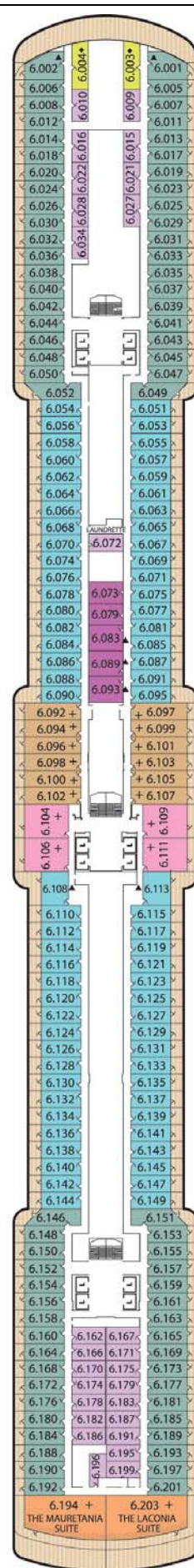

Deck 6

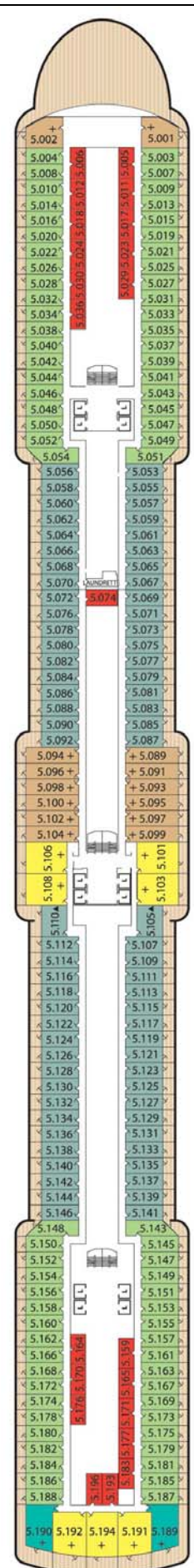

Deck 5



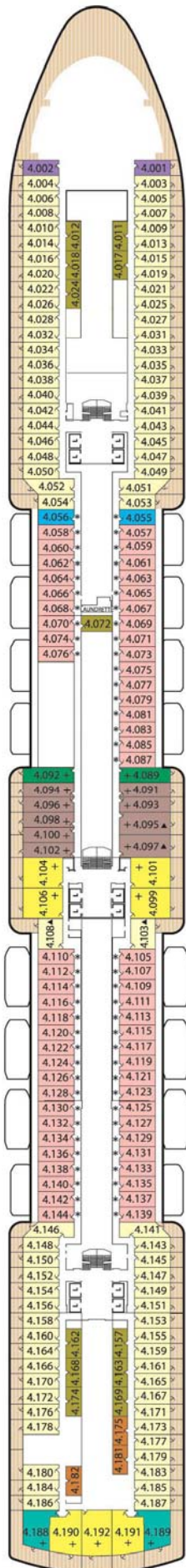

**Deck 4**  
**Queen Victoria**

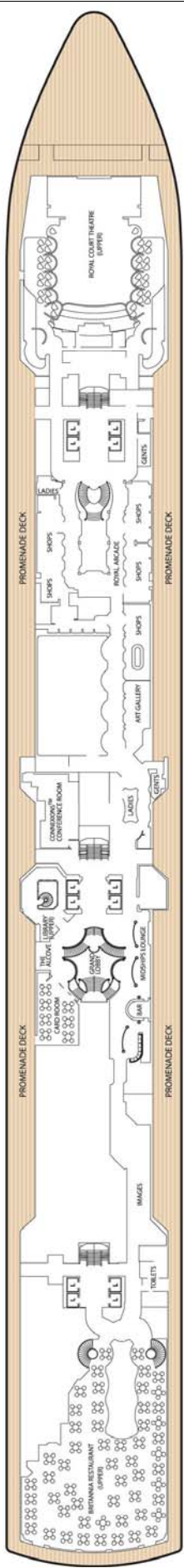

**Deck 3**

**1-800-845-1717**

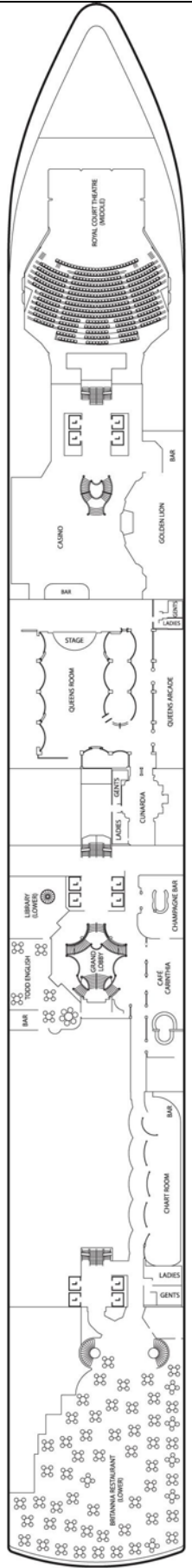

**Deck 2**

**Info@DeluxeCruises.com**

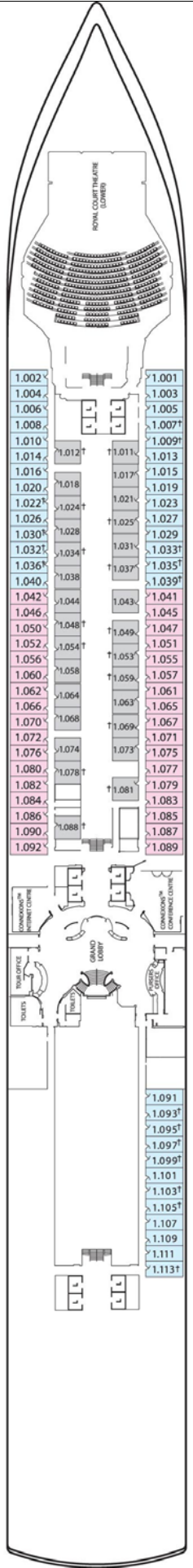

**Deck 1**

## Queens Grill – Stateroom Categories -- QV

Open Dining in Queens Grill – Dine When You Choose.

	Queens Grill Accommodations	Decks Fore, Aft, Mid
<b>Q1</b>	<b>Grand Suite</b>	
	6194, 6203 = 1918 Sq Ft 7142, 7159 = 2131 sq ft	Deck 6 Aft Deck 7 Aft
<b>Q2</b>	<b>Master Suite</b>	
	7070, 7085 = 1100 Sq Ft	Deck 7 Mid
<b>Q3</b>	<b>Penthouse</b>	
	8088-8091=520 sq ft	Deck 8 Mid
	8164, 8165=681 sq ft; 8166=664 sq ft	Deck 8 Aft
	6104, 6106, 6109, 6111= 551 sq ft	Deck 6 Mid
<b>Q4</b>	<b>Penthouse</b>	
	5101, 5103, 5106, 5108 = 556 sq ft	Deck 5 Mid
	5191, 5192, 5194 = 665 sq ft	Deck 5 Aft
	4101, 4104, 4106, 4109 = 596 sq ft	Deck 4 Mid
	4190, 4191, 4192 = 707 sq ft	Deck 4 Aft
<b>Q5</b>	<b>Queens Suite</b>	
	4188, 4189 = 757 sq ft	Deck 4 Aft
	5189, 5190 = 733 sq ft	Deck 5 Aft
	8162, 8163 = 771 sq ft	Deck 8 Aft
<b>Q6</b>	<b>Queens Suite</b>	
	Midship Deck 7 Various = 508 sq ft	Deck 7 Mid
	7030 Handicapped = 484 sq ft	Deck 7 Mid
<b>Q7</b>	<b>Queens Suite</b>	
	Suites 7036, 7037 -- 508 Sq Ft	Deck 7 Fore

## Princess Grill – Stateroom Categories -- QV

Open Dining in Princess Grill – Dine at Leisure.

	Princess Grill Accommodations	Deck
<b>P1</b>	<b>Princess Suite</b>	
	Midship Deck 7 Various = 345 sq ft	7 Mid
	Midship Deck 8 = 335 sq ft	8 Mid
<b>P2</b>	<b>Princess Suite</b>	
	Forward Deck 5 5001, 5002 = 377 sq ft	5 Fore
	Midship Deck 5 = 345 sq ft	5 Mid
	Except 5089, 5094 = 335 sq ft	5 Mid
	Midship Deck 6 = 346 sq ft	6 Mid
<b>P3</b>	<b>Princess Suite</b>	
	Midship Deck 4 = 367 sq ft	4 Mid
	Handicapped 4095, 4097 = 513 sq ft	4 Mid
<b>P4</b>	<b>Princess Suite</b>	
	Midship Deck 4: 4089, 4092 = 342 sq ft	4 Mid

## Britannia Restaurant Dining on QV

Choose Main Seating 6:30 pm or Second 8:30 pm

STATEROOM CATEGORIES		
		Deck
<b>A1</b>	Balcony	8
<b>A2</b>	Balcony	7, 8
<b>A3</b>	Balcony	6, 7
<b>A4</b>	Balcony	5, 6
<b>A5</b>	Balcony	5
<b>A6</b>	Balcony	4
<b>A7</b>	Balcony	4
<b>C1</b>	Oceanview	6
<b>C2</b>	Oceanview	1
<b>C3</b>	Oceanview	1
<b>C4</b>	Oceanview*	4
<b>C5</b>	Oceanview*	4
<b>D1</b>	Deluxe Inside	6, 8
<b>D2</b>	Deluxe Inside	1
<b>D3</b>	Standard Inside	8
<b>D4</b>	Standard Inside	7
<b>D5</b>	Standard Inside	6
<b>D6</b>	Standard Inside	5
<b>D7</b>	Standard Inside	4
<b>D8</b>	Standard Inside	4

\* C4 & C5 Staterooms have views obstructed by lifeboats

## Britannia Category Notes -- QV

- All Britannia Categories have Showers Only.
  - All Britannia Categories choose Main (early, 6:30 pm) or Second Seating (8:30 pm) for Dinner in the Britannia Restaurant.
  - Categories A1 through A5 have Deluxe Glass Balconies.
  - Categories A6 and A7 have Metal-Sided Balconies.
  - Most staterooms have 207 Square Feet of space in the room. D3 through D8 have 152 sq feet.
  - Private balcony A category rooms normally have 207 Square Feet, plus 35 Square Feet of Balcony, for a total of 242 Square Feet.
  - C Category rooms have windows but not balconies.
  - Categories C4 and C5 have views obstructed by lifeboats (i.e., no views).
- See additional details on the following pages.**

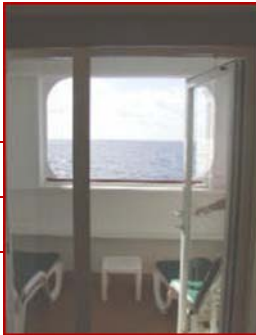
	<b>Britannia Restaurant Accommodations</b>	<b>Queen Victoria</b>
A1	<b>Deluxe Glass Balcony</b> (Depicted at Right)	
	Shower Only - 242 Sq Ft incl Balcony	
A2	<b>Deluxe Glass Balcony</b>	
	Shower Only - 242 Sq Ft incl Balcony	
A3	<b>Deluxe Glass Balcony</b>	
	Shower Only - 242 Sq Ft incl Balcony	
A4	<b>Deluxe Glass Balcony</b>	Deluxe Glass Balcony ▲
	Shower Only - 242 Sq Ft incl Balcony	
	Handicapped: 5110, 5105 = 278 Sq Ft Room + 161 Sq Ft Balcony	
A5	<b>Deluxe Glass Balcony</b>	Deck 5 Fore or Aft
	Shower Only - 242 Sq Ft incl Balcony	
A6	<b>Metal-Sided Balcony</b> -- Deck 4 -- Fore or Aft (Limits sunshine, wind, and view.) (Depicted right.)	
	Shower Only - 242 Sq Ft incl Balcony	
	Handicapped 4103, 4108	
A7	<b>Metal-Sided Balcony</b> -- Deck 4 -- Forward (Photo, right.) (Limits sunshine, wind, and view.)	
	Shower Only - 242 Sq Ft incl Balcony	Metal-Sided Balcony ▲
	<b>1-800-845-1717</b>	<b>Info@DeluxeCruises.com</b>

	<b>Britannia Restaurant Accommodations Continued</b>	<b>Queen Victoria</b>
	<b>Oceanview -- No Balcony.</b>	
C1	Oceanview -- Forward 6003, 6004	Deck 6 Fore
	Shower Only - 207 Sq Ft	
C2	Oceanview	Deck 1 - Lowest
	Shower Only - 207 Sq Ft	
C3	Oceanview	Deck 1 - Lowest
	Shower Only - 207 Sq Ft	
C4	Oceanview [Obstructed View]	Deck 4 - Lifeboat
	Shower Only - 207 Sq Ft	
C5	Oceanview [Obstructed View]	Deck 4 - Lifeboat
	4055, 4056 - Shower Only - 207 Sq Ft	
	<b>Interior Staterooms</b>	
D1	<b>Deluxe Inside</b>	Decks 6, 8
	Shower Only - 207 Sq Ft	
	6079 = 211 sq ft	
	6083, 6089, 6093 Handicapped = 243 sq ft	
	8033, 8037, 8047, 8051 = 200 sq	
D2	<b>Deluxe Inside</b>	Deck 1-Lowest Deck
	Shower Only - 207 Sq Ft	
D3	<b>Standard Inside</b>	Deck 8
	Shower Only = 152 sq ft	
D4	<b>Standard Inside</b>	Deck 7
	Shower Only = 152 sq ft	
D5	<b>Standard Inside</b>	Deck 6
	Shower Only = 152 sq ft	
D6	<b>Standard Inside</b>	Deck 5
	Shower Only = 152 sq ft	
D7	<b>Standard Inside</b>	Deck 4
	Shower Only = 152 sq ft	
D8	<b>Standard Inside</b>	Deck 4 Aft
	Shower Only = 152 sq ft <b>1-800-845-1717</b>	<b>Info@DeluxeCruises.com</b>